

West Entrance Niches

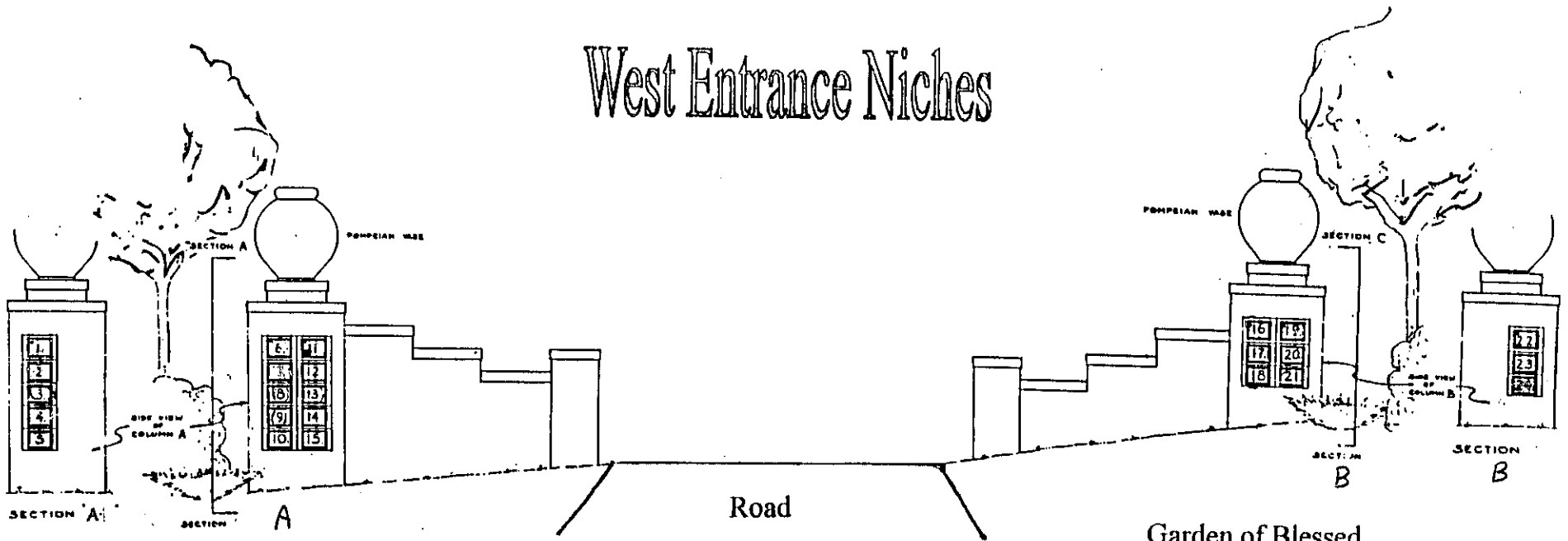

Garden of Gethsemane
NO9

Garden of Blessed
N11

SAMPLES

<p>MATTHEWS</p> <div style="border: 1px solid black; padding: 2px; margin: 2px;">HARRY C. 1949 - 2000</div> <div style="border: 1px solid black; padding: 2px; margin: 2px;">KRIS H. 1954 - 2010</div>	<p>MATTHEWS</p> <table style="width: 100%; border-collapse: collapse;"> <tr> <td style="border: 1px solid black; padding: 2px;">EDWARD J. 1890 - 1918</td> <td style="border: 1px solid black; padding: 2px;">SISSY M. 1900 - 1968</td> </tr> <tr> <td style="border: 1px solid black; padding: 2px;">EDWARD J. 1930 - 1977</td> <td style="border: 1px solid black; padding: 2px;">CAROL M. 1931 - 1981</td> </tr> </table>	EDWARD J. 1890 - 1918	SISSY M. 1900 - 1968	EDWARD J. 1930 - 1977	CAROL M. 1931 - 1981
EDWARD J. 1890 - 1918	SISSY M. 1900 - 1968				
EDWARD J. 1930 - 1977	CAROL M. 1931 - 1981				

COMPANION FOR TWO MAXIMUM OF FOUR
DEPENDING ON URN SIZE

BRONZE MEMORIAL DESIGN

Niche Selection - Column: _____ Niche: _____

Date: _____ Approved: _____ Approved: _____

THOMAS JEFFERSON MEMORIAL GARDEN MAUSOLEUM

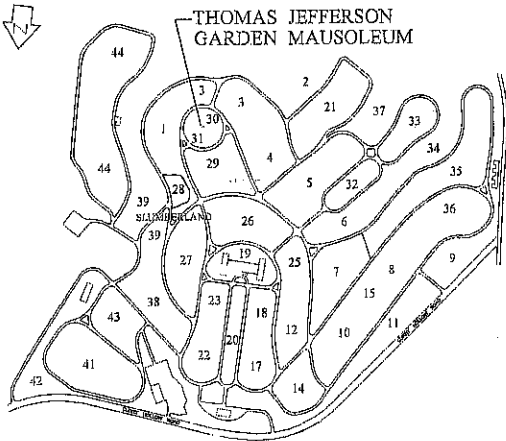
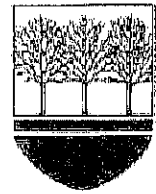

HISTORY OF MAUSOLEUM & COLUMNS

THESE COLUMNS ARE FROM THE FACADE OF THE BANK OF PITTSBURGH THAT ORIGINALLY STOOD ON FOURTH AVENUE. THE BANK OF PITTSBURGH WAS FOUNDED IN 1810 DURING THE LIFE OF THOMAS JEFFERSON. IT WAS THE OLDEST BANK IN THE UNITED STATES WEST OF THE ALLEGHENY MOUNTAINS. THESE 30 FOOT, 30 TON CLASSICAL COLUMNS GRACED A BUILDING, ERECTED IN 1895, OFTEN CALLED "PITTSBURGH'S OUTSTANDING EXAMPLE OF GRECIAN REVIVAL ARCHITECTURE IN ITS FINEST FORM". THE BUILDING STOOD UNTIL ABOUT 1940 WHEN IT WAS DEMOLISHED. THE CONCERN OF PITTSBURGH ARCHITECT EDWARD F. GRIFFITH WHO DID NOT WANT TO SEE THE HANDSOME FACADE DESTROYED, PERSUADED THE OWNERS TO LEAVE THE COLONADE INTACT WHEN THE REST OF THE BUILDING WAS DESTROYED. HE AGREED TO PAY RENTAL ON THE SPACE LOST TO PARKING. THE EMPTY FACADE STOOD UNTIL THE EARLY 1950'S WHEN THE FOURTH AVENUE PARKING GARAGE WAS SCHEDULED TO BE ERECTED ON THIS SITE. AGAIN, THESE COLUMNS WERE SCHEDULED FOR DEMOLITION. MANY EFFORTS WERE MADE BY SEVERAL GROUPS FOR THE PRESERVATION OF THE COLUMNS. (CONTINUED *)

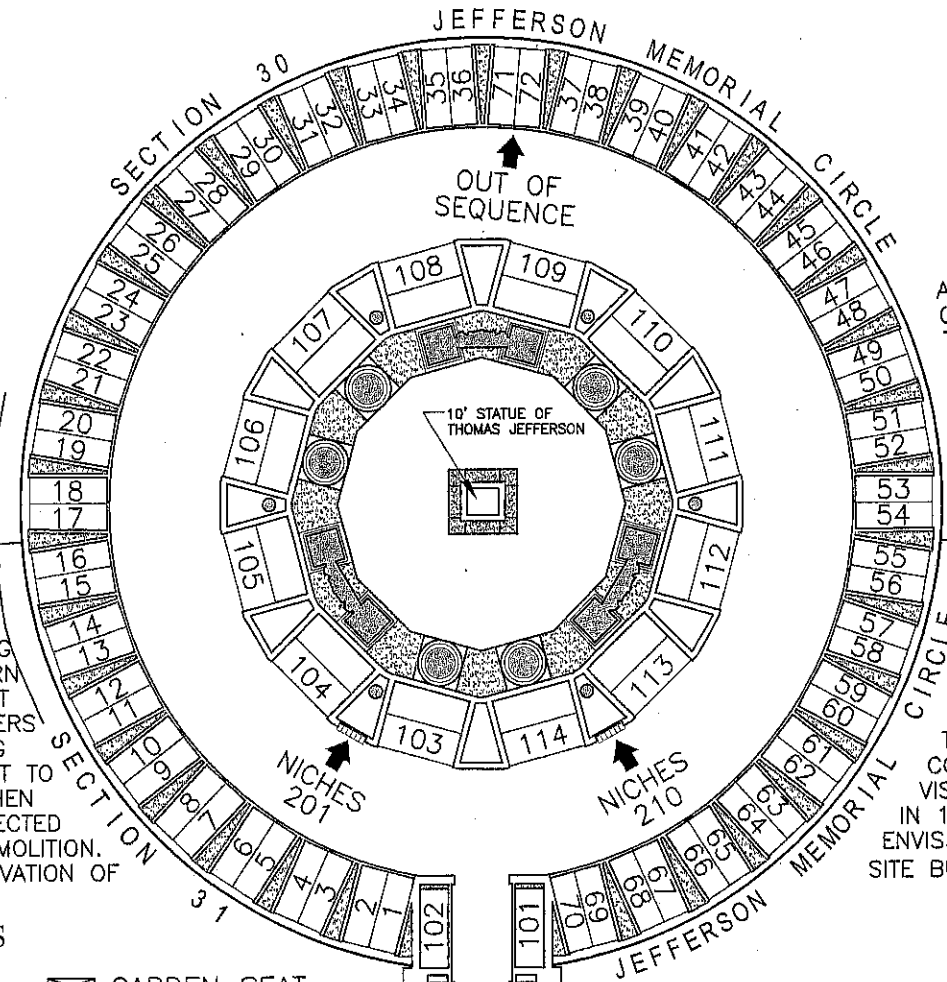

History Continued *

ALL THESE SCHEMES DIED ABORNING, EITHER DUE TO THE LACK OF INIATIVE, INSUFFICIENT PROMOTION OR MOST PROBABLY DUE TO THE EXCESSIVE COST OF REMOVAL. WHEN ALL EFFORTS SEEMED FUTILE, AND IT SEEMED THE IMPENDING DESTRUCTION OF THESE HANDSOME COLUMNS WERE AT HAND, MR. HARRY C. NEEL FOUNDER AND PRESIDENT OF JEFFERSON MEMORIAL PARK COMMITTED \$25,000.00, THE COST OF REMOVING THE COLUMNS, THE PILASTERS AND MOST OF THE FACADE AND TRANSPORTING IT TO THE CEMETERY. THERE, ALL THIS OUTSTANDING ARCHITECTURAL STONE WORK SAT ON THE SITE OF THE PRESENT JEFFERSON MAUSOLEUM FOR TEN YEARS. THEN HARRY C. NEEL AND HIS SON JOHN D. NEEL, WORKING WITH ARCHITECT, EDWARD GRIFFITH, DEVELOPED A PLAN WHERE THE COLUMNS AND THE PILASTERS ARE INCORPORATED IN A CIRCULAR DESIGN FORMING A PROTECTIVE CORDON AROUND A BRONZE 10 FOOT STATUE OF THOMAS JEFFERSON, SCULPTURED BY THE WELL KNOWN PITTSBURGH ARTIST FRANK VITTOR. THIS CIRCULAR DESIGN IS ELEVATED TO PERMIT CREATION OF THE 530 CRYPT GARDEN MAUSOLEUM. THIS BEAUTIFUL EDIFICE, CONSTRUCTED FROM 1960 TO 1962, IS THE CULMINATION OF THE VISION, DRIVE AND DETERMINATION OF THOSE BEFORE MENTIONED. IN 1930 THE ORIGINAL PLANS FOR JEFFERSON MEMORIAL PARK ENVISIONED A CIRCULAR MEMORIAL TO THOMAS JEFFERSON ON THIS SITE BUT IN A SOMEWHAT DIFFERENT FORM.

SECTION 201 - NICHES

LEVEL	A	B	C	D	E	F	TIER
16	S	S	S	S	S	S	
15							
14							
13							
12							
11							
10							
9							
8							
7							
6							
5							
4							
3							
2							
1	S	S	S	S	S	S	

GARDEN SEAT

NOTICE
Entry gate key
is available at
Administration
Building.

ROAD

NO URN REQUIRED.
REMAINS PLACED
DIRECTLY IN THE
NICHE.

S=SINGLE NICHE.
THE REMAINDER OF THE
NICHE ARE FOR TWO

SECTION 210 - NICHES

LEVEL	A	B	C	D	E	F	TIER
16	S	S	S	S	S	S	
15	S	S	S	S	S	S	
14	S	S	S	S	S	S	
13							
12							
11							
10							
9							
8							
7							
6							
5							
4							
3							
2							
1	S	S	S	S	S	S	

BRONZE NAME PLATES FOR NICHES

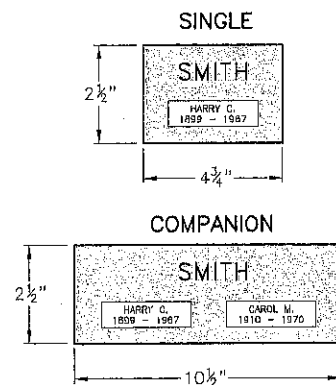

CRYPT LAYOUT

Outer Wall - B, C, D are single Depth Side by Side Individual Fronts. The A/A is now called A/AA (1/1) are Companion Westminster.

Inner Wall - B, C, D, E, F, are Couch Crypt True Companion Fronts. The A/A is now called A/AA (2/1) Family Westminster. The footer takes 4th space.

530 Casket spaces in TJGM
192 Niche placement in TJGM

Cemetery: (412) 655-4500

Funeral Home: (412) 655-4501

Jefferson Memorial Cemetery and Funeral Home, 401 Curry Hollow Road, Pittsburgh, PA 15236

Original Map: June 25, 1962
Computerized: November, 2003

N32

GARDEN OF THE TEMPLE
CREMATION NICHES

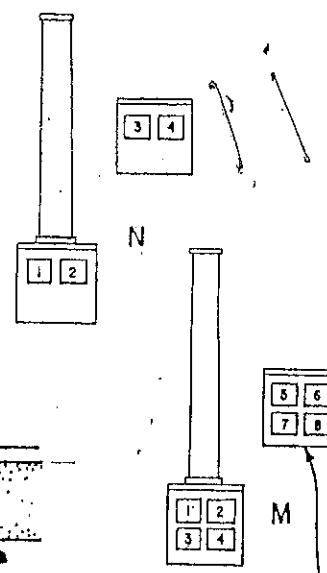
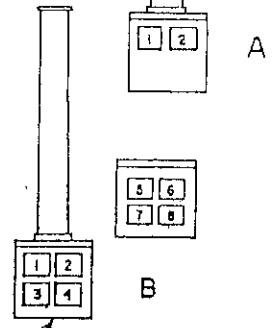
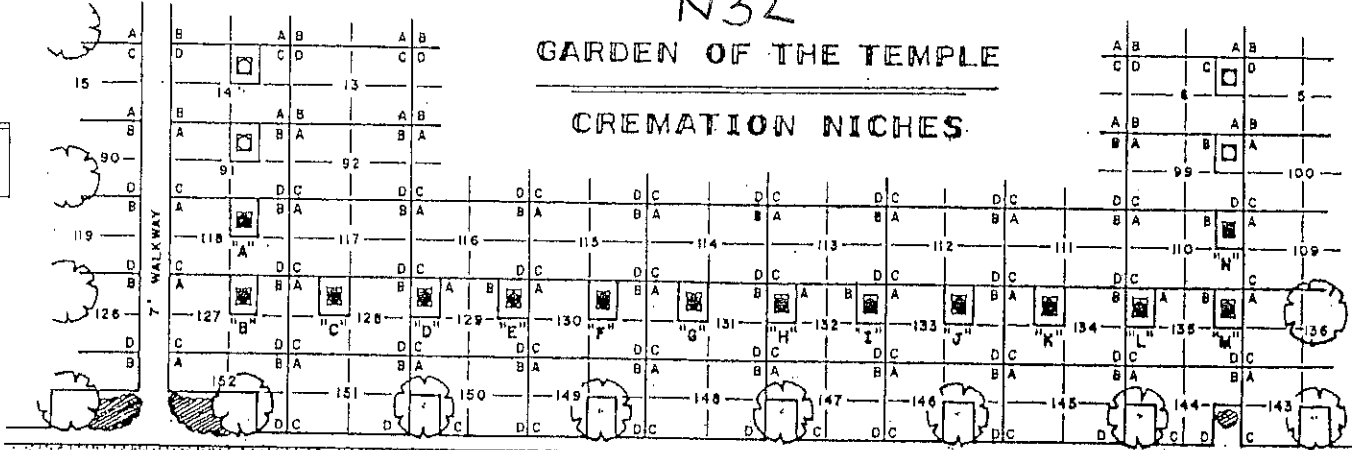

TYPICAL COLUMN FACING KINGDOM

TYPICAL COLUMN FACING PEACE

GARDEN OF THE KINGDOM

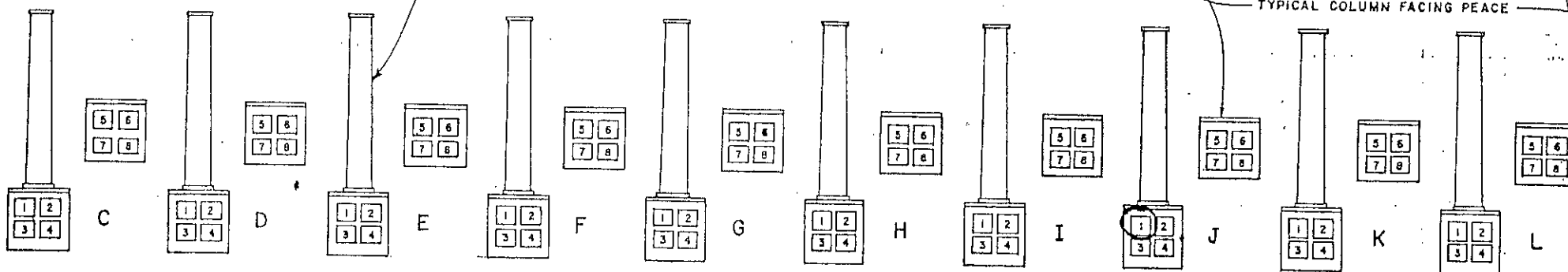

SAMPLES

BRONZE MEMORIAL DESIGN

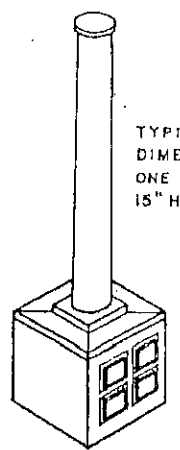

TYPICAL NICHE
DIMENSION FOR
ONE UNIT :
15" H x 18 1/2" W x 19 3/4" D

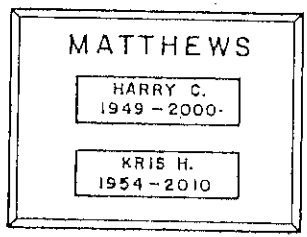

COMPANION FOR TWO

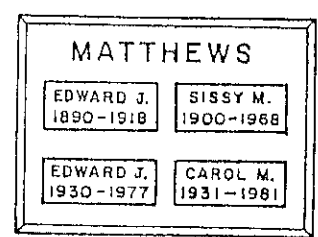

MAXIMUM OF FOUR
DEPENDING ON URN SIZE

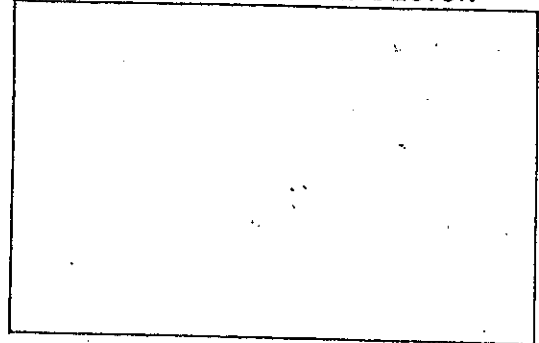

TEMPLE NICHE SELECTION — COLUMN : _____ NICHE # : _____

APPROVED : _____ APPROVED : _____

GARDEN OF FREEDOM
SECTION N44
FEATURE MAUSOLEUM
AND NICHE COLUMBARIUM

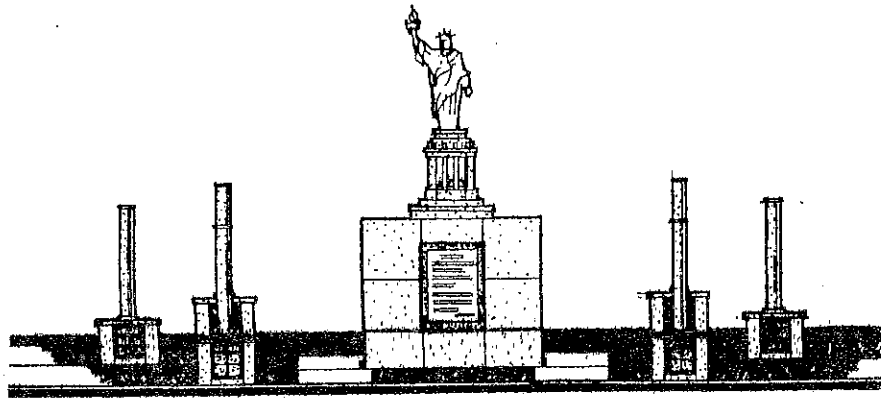

STATUE OF LIBERTY MAUSOLEUM

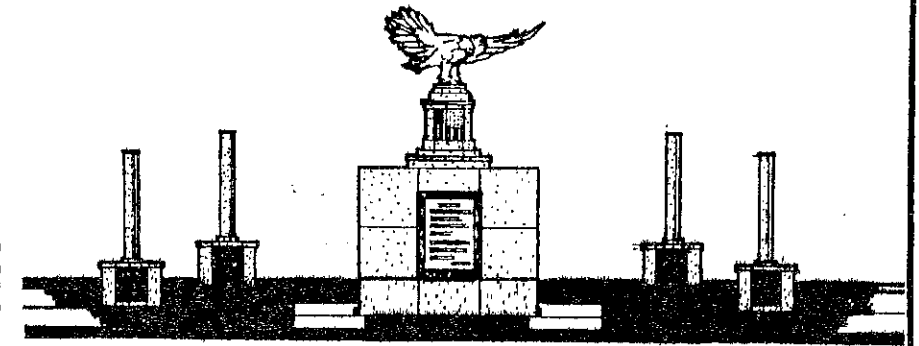
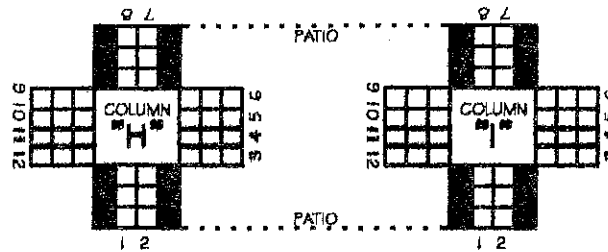

AMERICAN EAGLE MAUSOLEUM

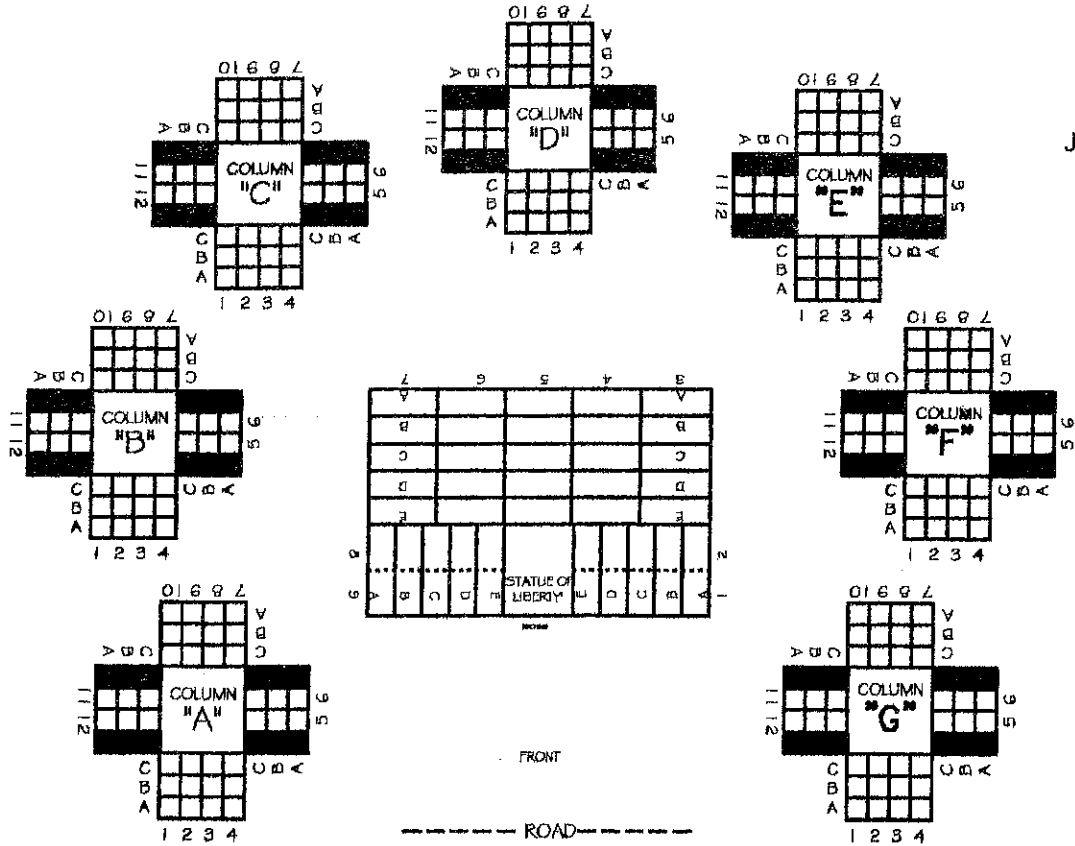

JEFFERSON MEMORIAL CEMETERY
AND FUNERAL HOME
401 CURRY HOLLOW ROAD
PITTSBURGH, PA 15236
(412) 655-4500

INTERIOR DIMENSIONS;
CRYPTS: 2'-7 1/2" X 7'-4 1/2" X 2'-2 1/16"
NICHE: 11 3/4" X 11 3/4" X 11 3/4"

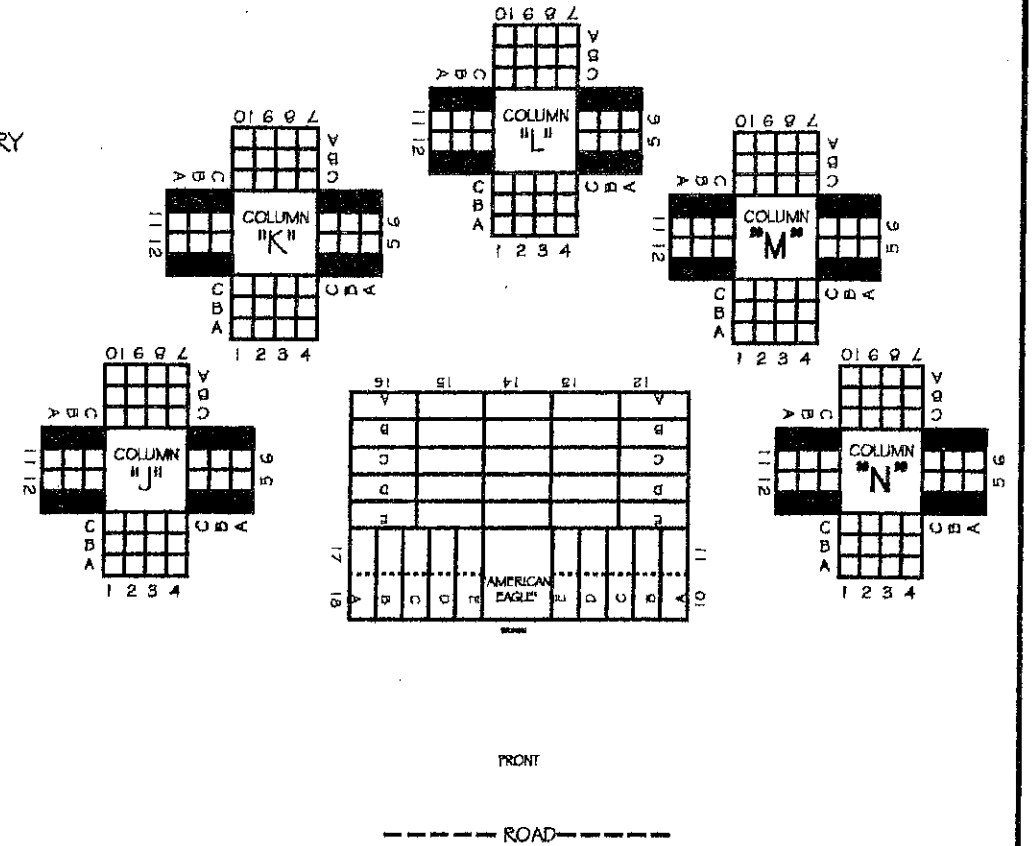

THE GARDEN OF FAITHFUL FRIENDS MAUSOLEUM AND NICHE

Located within SECTION N₄₅



This Garden allows a Pet to be interred individually or with their Pet Parent.

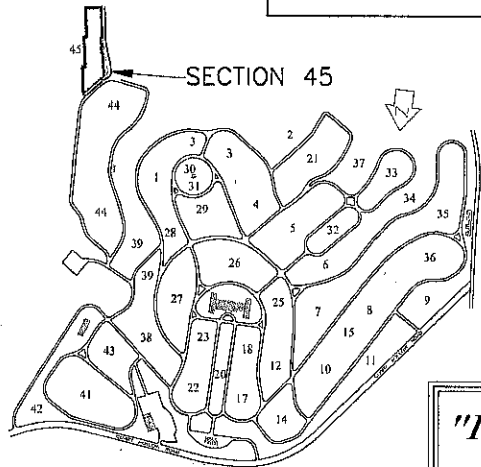
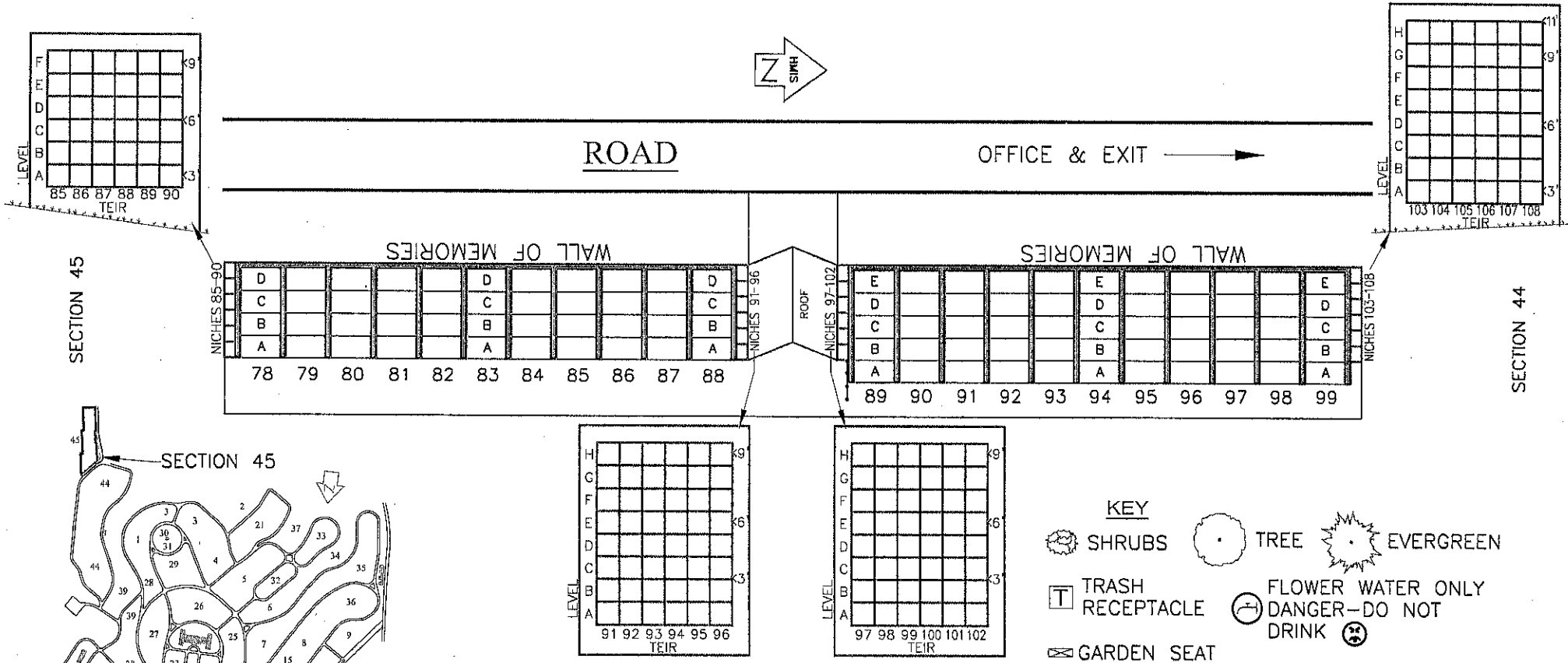

*"In our gardens repose the remains of those that possess beauty without vanity,
strength without insolence, courage without ferocity,
and the virtues of man without his vices: our pets."
~ Lord Byron*

INTERIOR DIMENSIONS

NICHE UNIT: 11"W x 11"H x 9"D
 *SINGLE DEPTH CRYPTS: 2'-8"W x 2'-3"H x 7'-4½"D
 *(NORWALK CRYPTS BY JMP)

Phase I 2010
 by Jefferson
 Robert Stevens, Architect

99 CRYPT CASKET PLACEMENTS
 & 180 NICHE UNITS IN FAITHFUL
 FRIENDS GARDEN MAUSOLEUM
 THRU PHASE I.

Cemetery: (412) 655-4500 Funeral Home: (412) 655-4501
 Jefferson Memorial Cemetery and Funeral Home, 401 Curry Hollow Road, Pittsburgh, PA 15236

Original Map: January, 2010
 Revised: April 2010